

# CERTIFICATE OF LOCATION OF GOVERNMENT CORNER

**Northeast** Corner of Section **22** , Township **107** , Range **41** 5th P.M.

STATE OF MINNESOTA, County of Murray.

**Statement:** Sept. 6, 1989 - Found a deteriorated oak stake. Placed a Minnesota Department of Transportation Aluminum Capped Square Iron Monument.



## SKETCH OF REFERENCE TIES

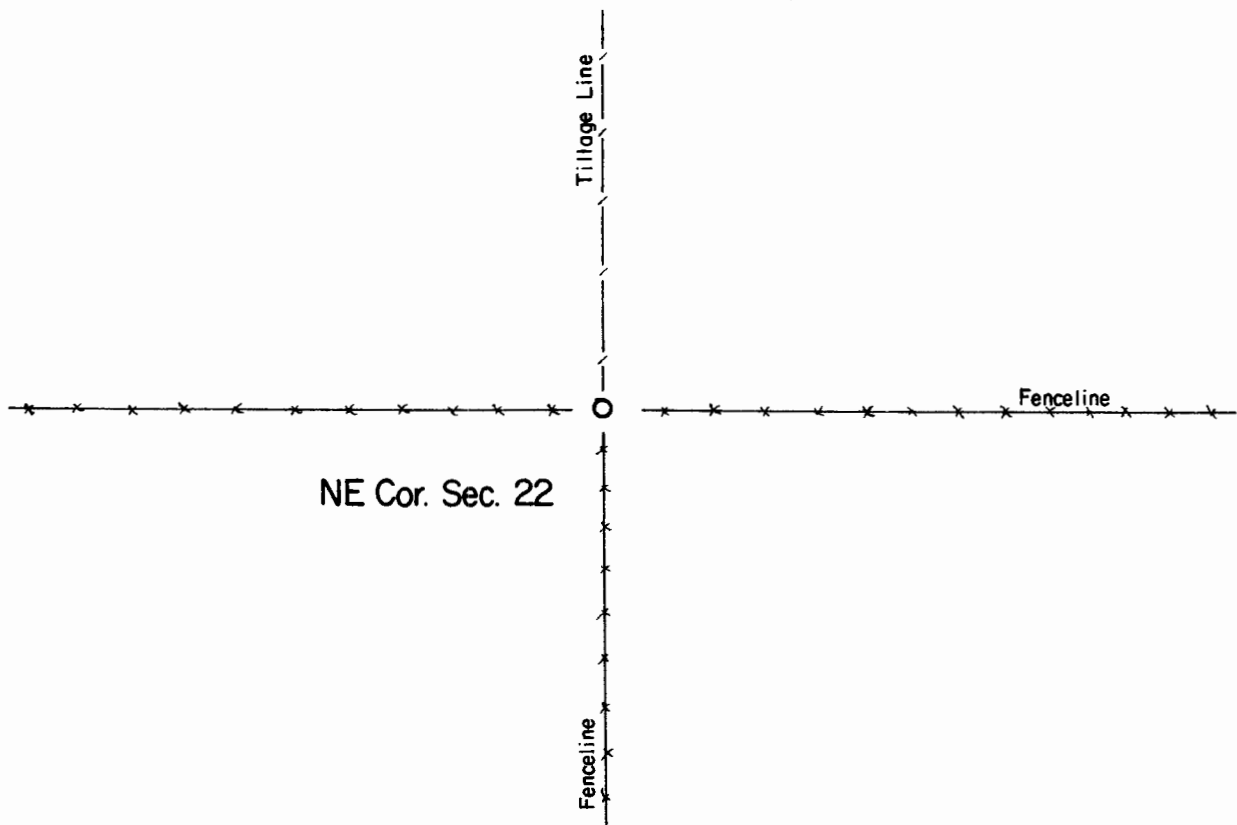

Statement of evidence relative to this corner location is on the back of page.

I hereby certify that this document and the data contained herein was prepared by me or under my direct supervision and that I am a duly Registered Land Surveyor under the laws of the State of Minnesota.

 Nov 4, 1989  
Duane A. Bonnema Date

Minnesota Registration No. 14895

OFFICE OF THE COUNTY RECORDER  
COUNTY OF MURRAY **NOV 15 1989**

I hereby certify that this document was filed in the County Recorder's office at \_\_\_\_ M. on the \_\_\_\_ day of \_\_\_\_\_ A.D., 19\_\_

County Recorder 

By \_\_\_\_\_, Deputy  
DOCUMENT NO. \_\_\_\_\_

Northeast Cor. Sec. 22 T107N-R41W

*Statement:*

*August 1861*

*Original Government Land Office Surveyor L. G. M. Fletcher records in his field notes, "built mound with trench pits, charred stake, per instructions."*

*Sept. 6, 1989*

*Duane A. Bonnema, LS Reg. No. 14895, found what appeared to be a badly deteriorated charred oak stake below a stone pile near the corner fence post. The oak stake had a 5 inch x 6 inch x 12 inch stone standing on the north side of it. The oak stake appears to be the best available evidence of the Section Corner location. A Minnesota Department of Transportation Aluminum Capped Iron Monument was placed near the ground surface.*